

Short Thrust layout

This is the default layout

Options for stage size (approx) and seating (approx):

- 4.2m W x 3.95m D with 39 seats
- 4.2m W x 3.1m D with 47 seats
- 4.2m W x 2.25m D with 54 seats

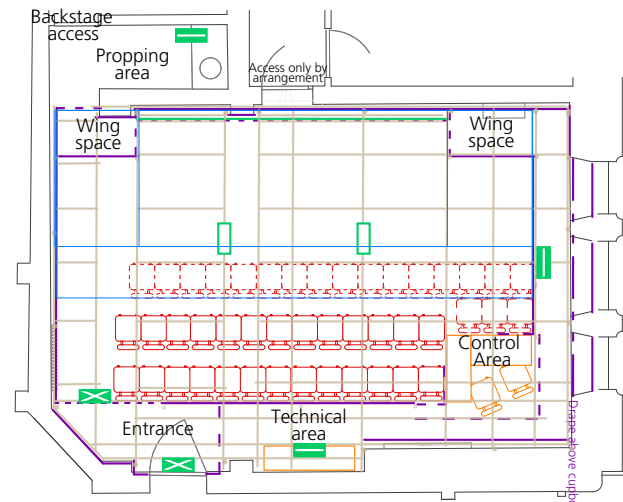

Wide End-on layout

May be available by arrangement (standard turnaround time)

Options for stage size (approx) and seating (approx):

- 7.9m W (5.1m W upstage) x 3.1m D with 26 seats
- 7.9m W (5.1m W upstage) x 2.8m D with 29 seats
- 7.9m W (5.1m W upstage) x 2.5m D with 42 seats

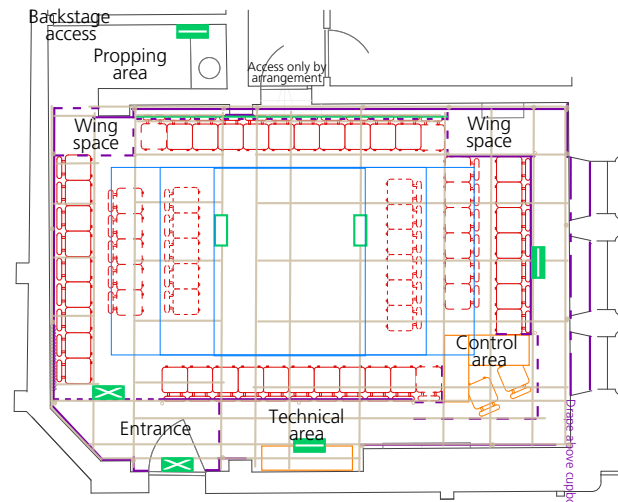

In-the-Round layout

May be available by arrangement (standard turnaround time)

Options for stage size (approx) and seating (approx):

- 6.1m W x 3.1m D with 39 seats
- 4.4m W x 3.1m D with 50 seats
- 2.5m W x 3.1m D with 60 seats

key

- escape route sign (maintained)
- bulkhead (maintained)
- bulkhead (non-maintained)
- scaffolding at grid height
- scaffolding standard
- black drape
- openable black drape on track
- open black drape on track
- projection screen
- edge of playing area
- seats (fixed)
- seats (removable by arrangement)
- seats (may be added by arrangement)

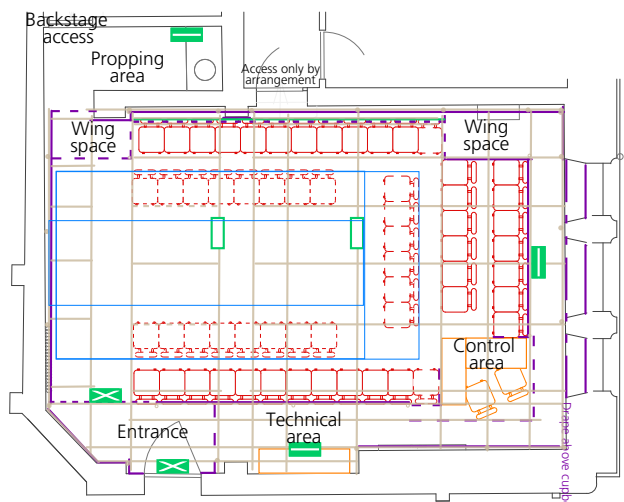

Long Thrust layout

May be available by arrangement (additional turnaround time required)

Options for stage size (approx) and seating (approx):

- 3.1m W x 6m D with 37 seats
- 3.1m W x 5.1m D with 43 seats
- 1.4m W x 6m D with 53 seats
- 1.4m W x 5.1m D with 59 seats

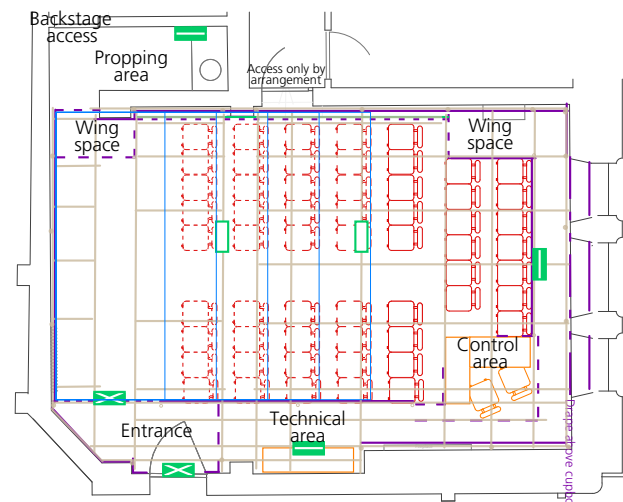

Deep End-on layout

May be available by arrangement (additional turnaround time required)

Options for stage size (approx) and seating (approx):

- 4.7m W x 5.2m D with 22 seats
- 4.7m W x 4.35m D with 31 seats
- 4.7m W x 3.5 D with 40 seats
- 4.7m W x 2.65 D with 49 seats
- 4.7m W x 1.8 D with 58 seats

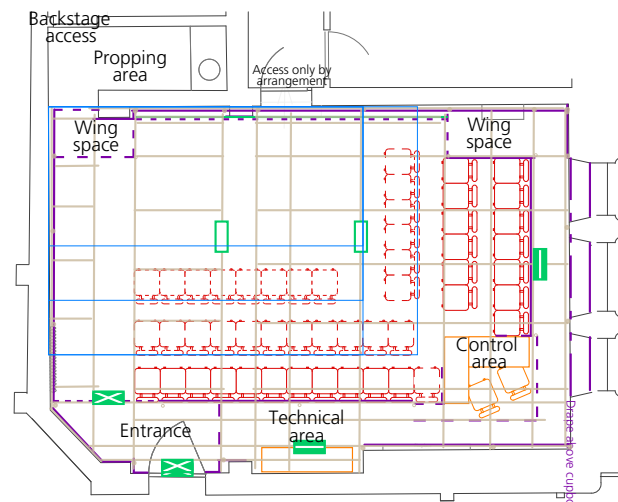

Corner layout

May be available by arrangement (standard turnaround time)

Options for stage size (approx) and seating (approx):

- 6.1m W x 4.1m D with 25 seats
- 5.2m W x 4.1m D with 31 seats
- 5.2m W x 3.2 D with 42 seats
- 5.2m W x 2.3 D with 50 seats

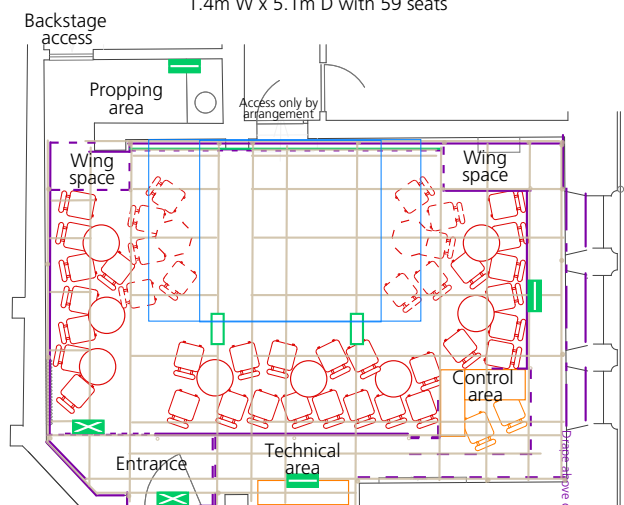

Cabaret layout

May be available by arrangement (additional turnaround time required)

Options for stage size (approx) and seating (approx):

- 3m W x 3m D with 40 seats
- 4.5m W x 3m D with 30 seats

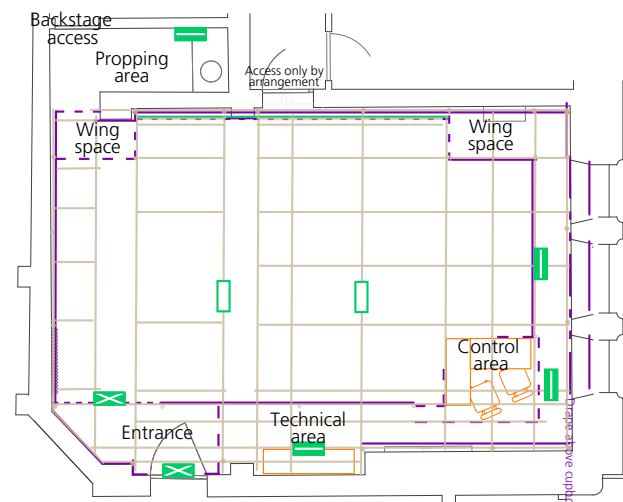

Empty space layout

May be available by arrangement (additional turnaround time required)

Open space size 36.82 sq m approx

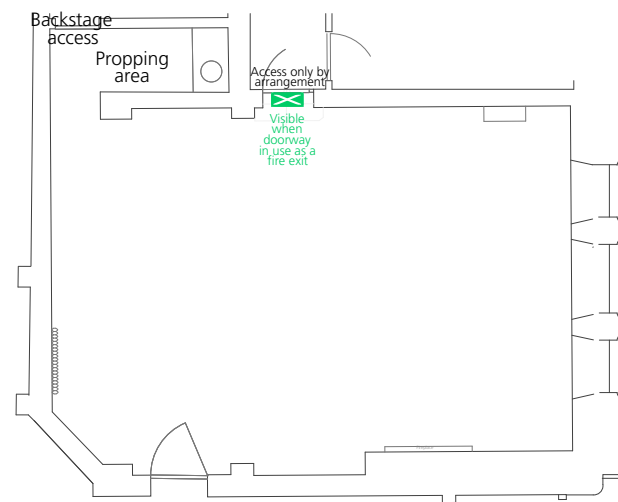

Empty room layout

This layout is shown for information but is not available during the current season

Room size 49.97 sq m approx

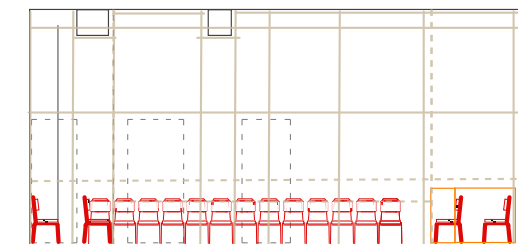

Section

Auditorium approx 8.6m L x 5.6m W
 Ceiling height approx 3.46-3.86m
 Clearance under lighting bars approx 3.3m, under lights approx 3m

This plan is indicative and subject to change
 All critical details should be verified in situ

For further information please contact C venues on
 +44 (0)131 581 5520 or email production@cvenues.com

Copyright © C ARTS IC venues – plan updated 6 October 2023

Approximate Scale

